



## BUILDING INFORMATION

Availability	180,532 SF
Divisibility	45,000 SF
Building Area	180,532 SF
Office Space	To Suit
Clear Height	30' Clear
Car Parking	197 Spaces
Loading	18 Docks (Expandable) 4 Drive-in Doors
Bay Size	55'6" x 52'6" 60'0" Speed Bay
Fire Protection	ESFR System
Power	3,000 Amps
Lighting	High Bay LED Fixtures
Construction	Pre-Cast Panel

## AREA INFORMATION

Zilber Industrial II at Lilly Creek Business Park is a 180,532 square foot industrial building and able to accommodate users from 45,000 SF to 180,532 SF.

## ADDITIONAL INFORMATION

- Access to US-45 via Silver Spring Drive and Mill Road
- Low Waukesha County real estate taxes
- Potential rail service
- Access to large Milwaukee County and Waukesha County skilled and unskilled labor force
- Professional local ownership and management

## TRAVEL TIMES

- 25 minutes to General Mitchell International Airport
- 20 minutes to downtown Milwaukee
- 10 minutes from Zoo Interchange (US-45 and I-94)
- 10 minutes to Milwaukee County Regional Medical Center
- 5 minutes to Mayfair Road and Mayfair Mall

For more information visit [www.zilberpropertygroup.com](http://www.zilberpropertygroup.com)

### MICHAEL KLEBER

Director of Industrial Leasing  
Michael.Kleber@Zilber.com  
(414) 274-2628

### ZILBER PROPERTY GROUP

710 N Plankinton Ave  
Milwaukee, WI 53203  
(414) 274-2623

## SITE PLAN

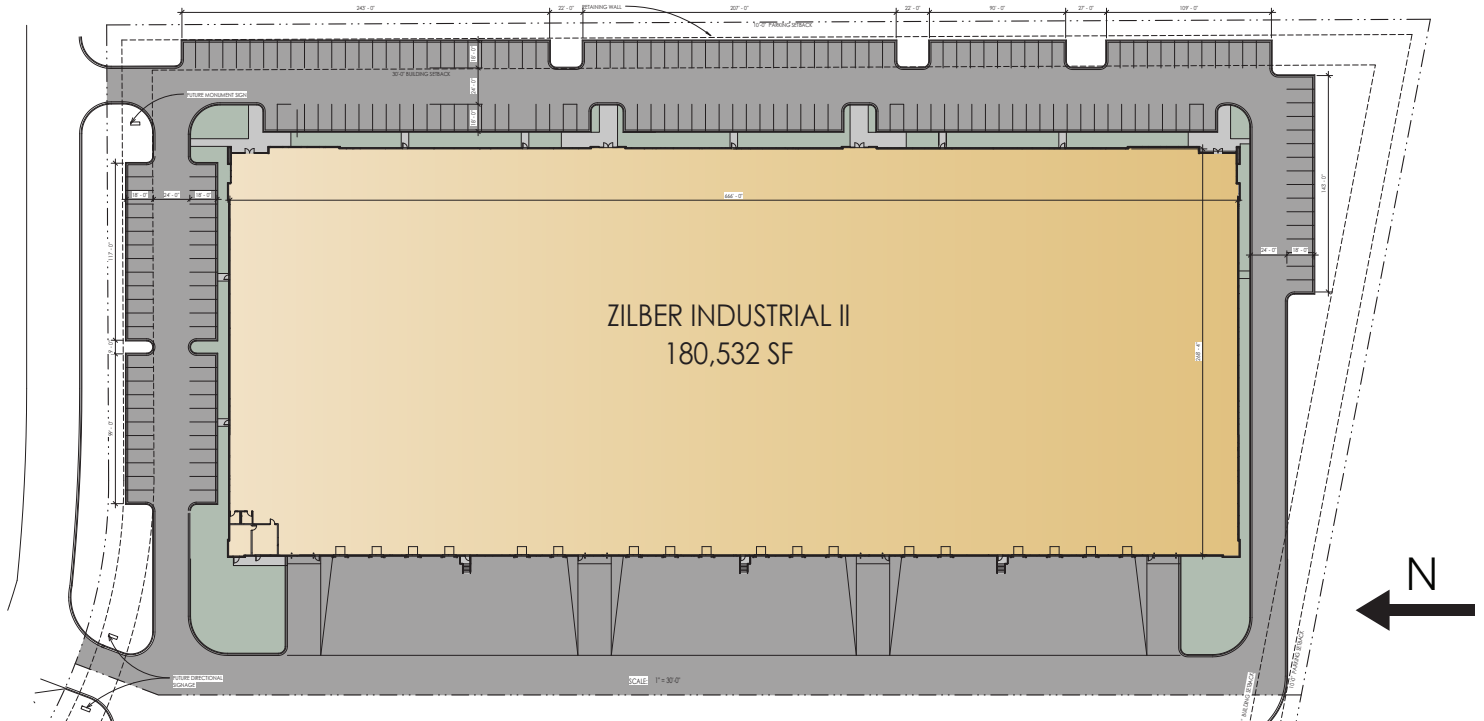

## LOCATION MAP

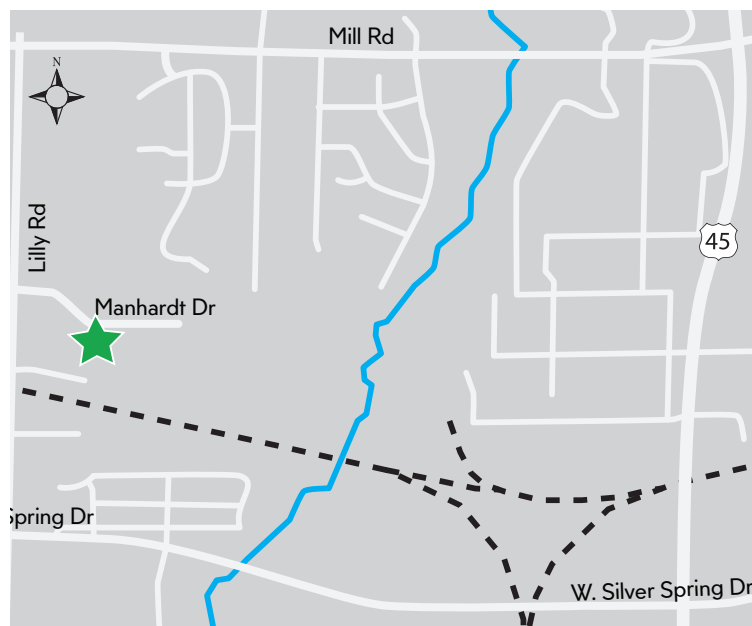

For more information visit [www.zilberpropertygroup.com](http://www.zilberpropertygroup.com)

**MICHAEL KLEBER**  
Director of Industrial Leasing  
Michael.Kleber@Zilber.com  
(414) 274-2628

**ZILBER PROPERTY GROUP**  
710 N Plankinton Ave  
Milwaukee, WI 53203  
(414) 274-2623